



## MANUAL MOUNTINGPLATES AL-KO SLC CHASSIS

Please read this manual carefully and keep it for future reference.

[www.hpc-hydraulics.com](http://www.hpc-hydraulics.com)



## MANUAL AL-KO SLC CHASSIS

Bolts and nuts are supplied with the steel parts for attaching the mountingplates and jacks.

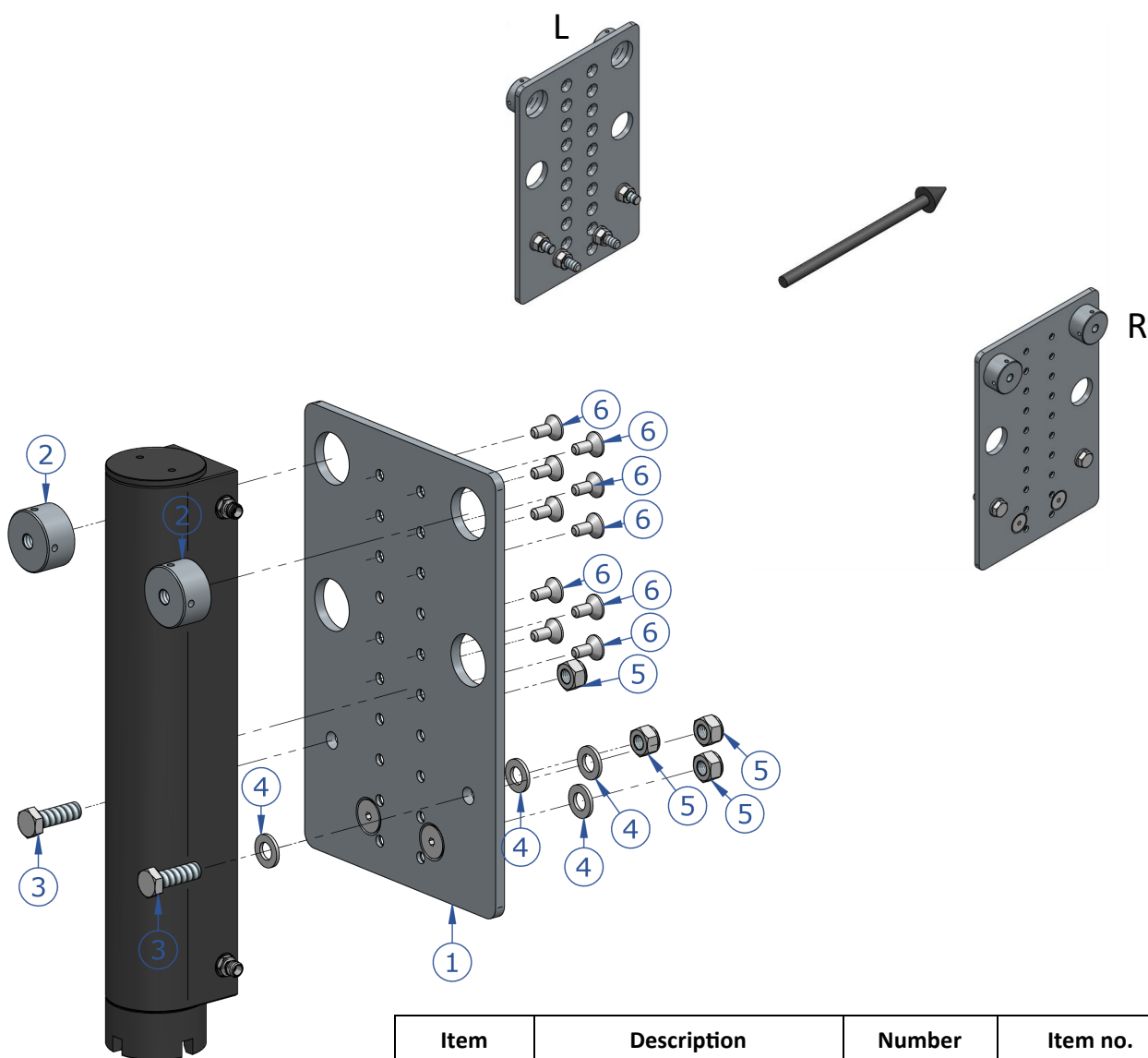

Item	Description	Number	Item no.
1	Baseplate SLC	2	HPC.BR.ALKO.I
2	Fastening nut SLC	4	H.MOER 12x1,5
3	Six-sided bolt M12 x 40	2	D1811
4	Washer M12	6	D2304
5	Locknut M12	4	D2034
6	Countersunk bolt M8 x 20	10	D29605

---

## MANUAL AL-KO SLC CHASSIS

---

The ground clearance, calculated from the dish, must be at least 17 centimeters. Before the mounting plates are finally attached, the height for mounting the jacks must be determined.

If the vehicle is fitted with air suspension, this must be taken into account when determining the installation height.

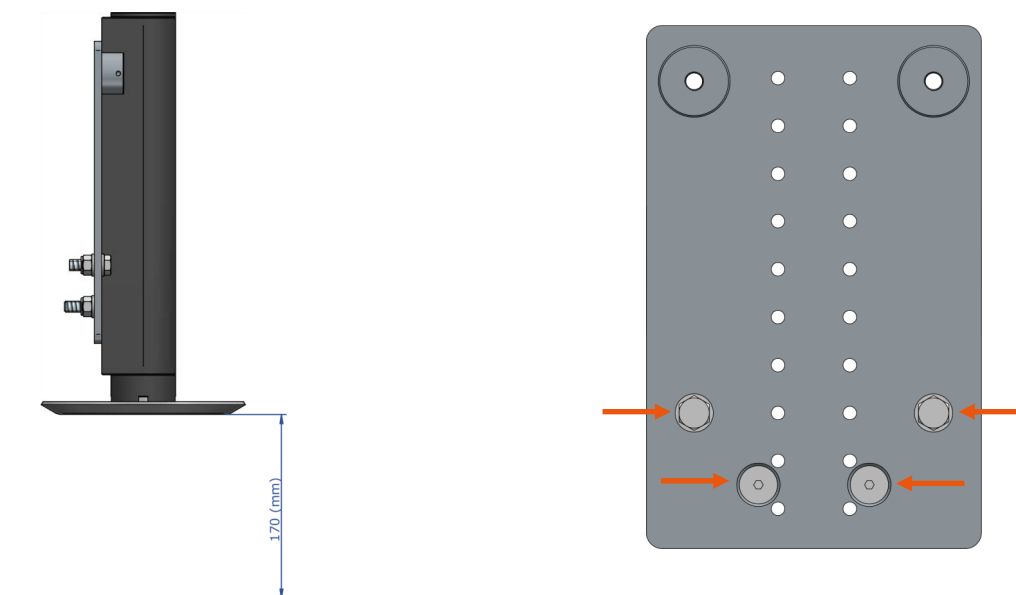

Temporarily mount the mounting plate with the M12 bolts. This makes it easy to determine the height. Take into account the foot that has yet to be placed. Allow 1 centimeter extra for this.

After the height has been determined, it should be checked whether the use of a stabilizing bar is necessary. If so, continue reading on page 6.  
The stabilizing bar comes with mounting material.



Item	OmschrijvingDescription	Number	Article number
1	Stabilizing bar	1	HPC.BR.CROSS
2	Six-sided bolt M8 x 25	8	D25600
3	Washers SKM8	8	D8258
4	Six-sided bolt M10 x 45	1	D37907
5	Self-locking nut M10	1	D29609

---

## MANUAL AL-KO SLC CHASSIS—without stabilizing bar

---

Remove the mounting plate and mount the jack at the correct height using 10 bolts. Position the bolts so that the is secured in as many positions as possible. See the image below.

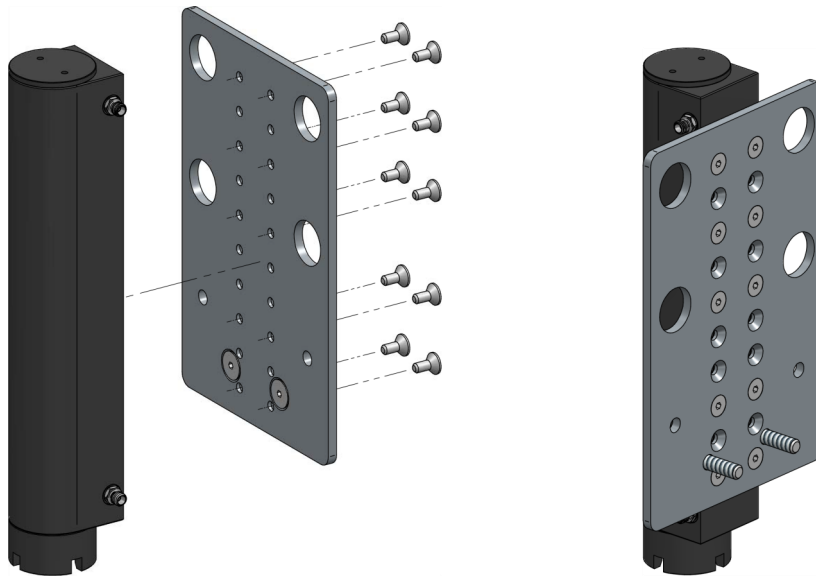

The mountingplate including jack, is now placed directly on the chassis.

Mount the mountingplates with the six-sided bolts M12 x 40, washers and locknuts. See the left image below.

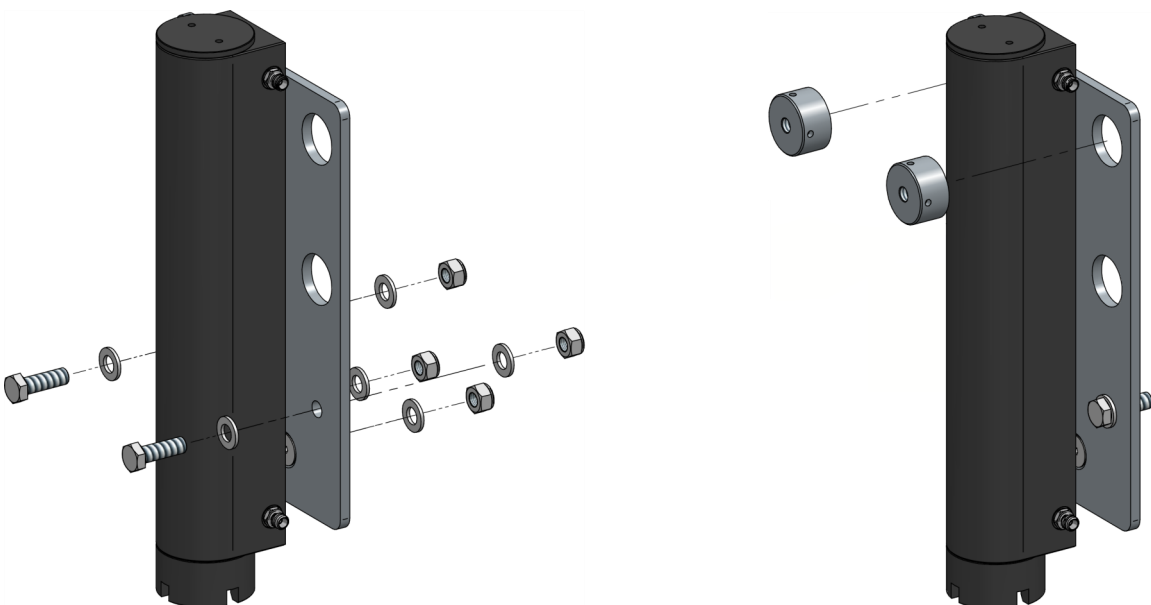

---

## MANUAL AL-KO SLC CHASSIS—without stabilizing bar

---

The image below shows a correct installation. The height of the jacks may be different from as shown; this differs per vehicle.



---

## MANUAL AL-KO SLC CHASSIS - with stabilizing bar

---

Before the stabilizing bar can be mounted, holes must be drilled in the mounting plate. Determine the position for attaching the stabilizing bar. The arrows on the mounting plate in the images below indicates how to drill.

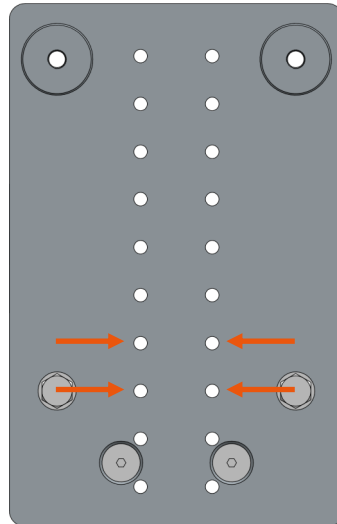
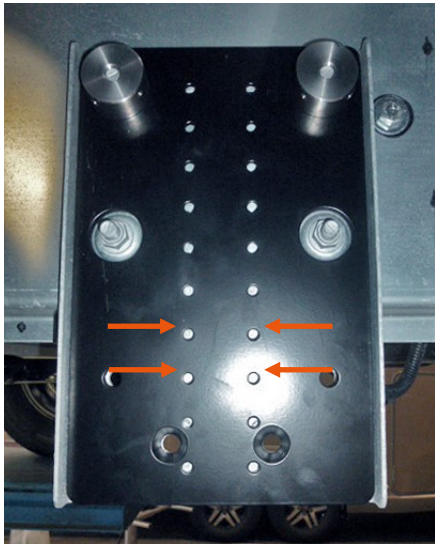

Disassemble the mounting plate after the holes have been drilled. Mount the jack at the correct height and fix it with the 10 countersunk bolts M8 x 20 supplied. Position the bolts so that the jack is secured in as many positions as possible. See right image below.

! Do not install bolts in the stabilizing bar attachment positions.

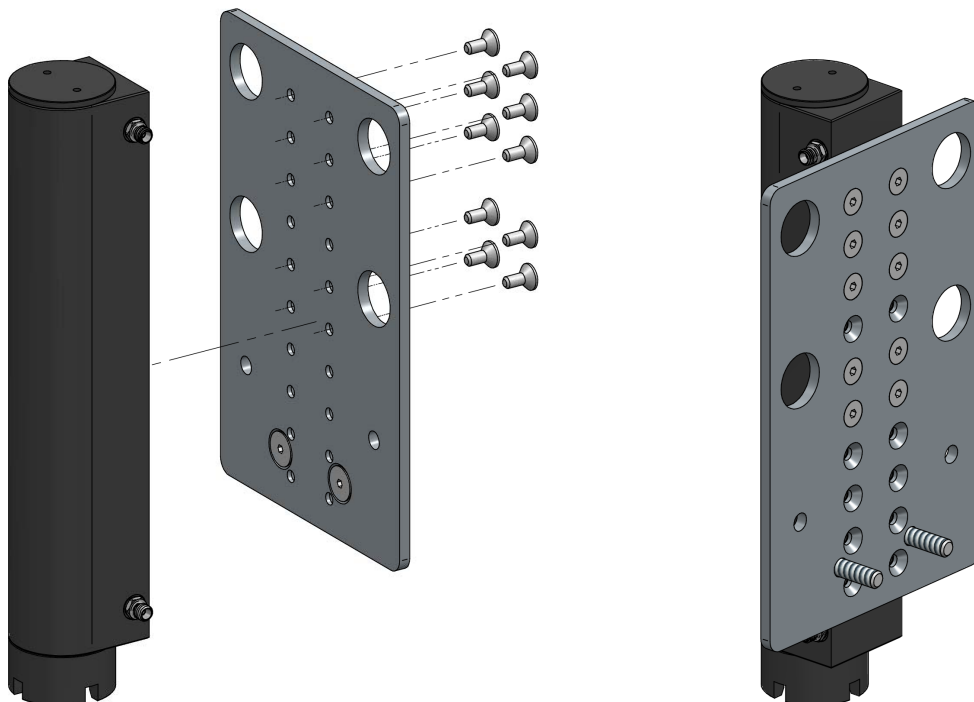

---

## MANUAL AL-KO SLC CHASSIS

---

Place the mounting plate including jack on the chassis.

Mount the mounting plate with the six-sided bolts M12 x 40, washers and locknuts. See left image below.

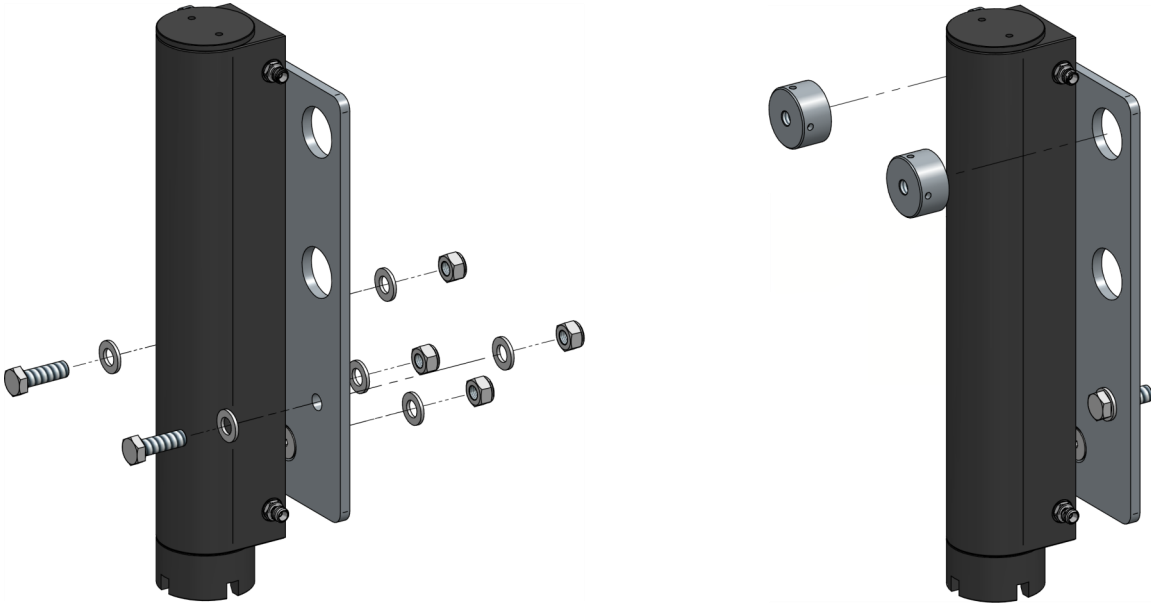

Place the stabilizing bar between the mounting plates and attach it where the holes are drilled. Fasten the stabilizing bar with six-side bolts M8 x 25 and springwashers. (If for some reason this is not possible, use a small amount loctite so that the bolts can be looseended later without causing damage.)

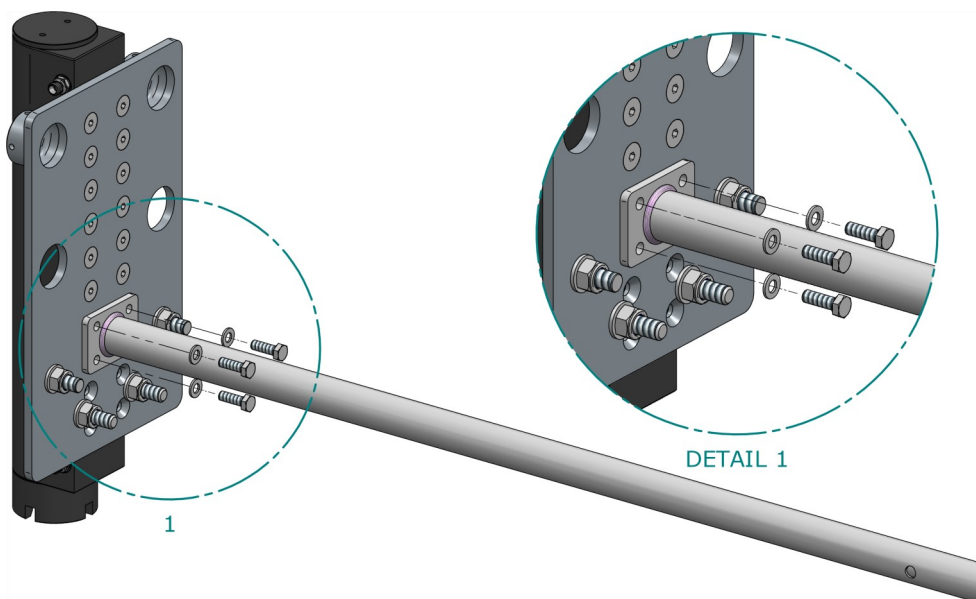

---

## MANUAL AL-KO SLC CHASSIS - with stabilizing bar

---

The image below shows a correct installation. The height of the jack may be different from as show; this differs per vehicle.





HPC HYDRAULICS B.V.  
Edisonstraat 18-20 7575 AT Oldenzaal  
Tel: 00-31-(0)541 222 444  
E-mail: [info@hpc-hydraulics.com](mailto:info@hpc-hydraulics.com)